



金洋實業有限公司

KAM YEUNG COMPANY LIMITED

EEZEE-DRY®

太陽牌活動晾衫架
Solar Brand Drying Rack

專營：鋁質不鏽鋼製品、活動晾衫架
各款信箱、保安門閘、家庭用品
遙控電動窗簾

易曬牌活動晾衫架
Aluminium Drying Rack

Your Ref:

Our Ref:

Date:

「太陽牌」遙控電動窗簾機系列
“Solar Brand” Electric Remote Control Curtain Systems

產品目錄
Brochure

內容
Content

產品彩圖
Catalogue

產品圖紙
Shop Drawing

各項証書
Certificates

工作記錄 (相片版)
Job Reference (Photos)

工作記錄 (文字版)
Job Reference (Text)

ADDRESS : FLAT C, 2/FL., BLOCK 3, GOLDEN DRAGON INDUSTRIAL CENTRE,
172-180 TAI LIN PAI ROAD, KWAI CHUNG, N. T., KOWLOON, HONG KONG
WEBSITE : <http://www.kamyeung.com>

E-MAIL: kamyeung1980@yahoo.com.hk
kamyeung1990@gmail.com

TEL: 852-2428 3296, 2424 7485
FAX: 852-2480 3346



金洋實業有限公司

KAM YEUNG COMPANY LIMITED

EEZEE-DRY®

太陽牌活動晾衫架
Solar Brand Drying Rack

專營：鋁質不鏽鋼製品、活動晾衫架
各款信箱、保安門閘、家庭用品
遙控電動窗簾

易曬牌活動晾衫架
Aluminium Drying Rack

Your Ref:

Our Ref:

Date:

產品彩圖

Catalogues

ADDRESS : FLAT C, 2/FL., BLOCK 3, GOLDEN DRAGON INDUSTRIAL CENTRE,
172-180 TAI LIN PAI ROAD, KWAI CHUNG, N. T., KOWLOON, HONG KONG
WEBSITE : <http://www.kamyeung.com>

E-MAIL: kamyeung1980@yahoo.com.hk
kamyeung1990@gmail.com

TEL: 852-2428 3296, 2424 7485
FAX: 852-2480 3346



太陽牌
Solar Brand

中國專利號：200420120189.X
200620001384.X
200620004288.0
200720002510.8
200720002511.2
200720155960.0

CHINA PATENT APPLICATION:
200420120189.X
200620001384.X
200620004288.0
200720002510.8
200720002511.2
200720155960.0

英國專利號：0502235.5
UK PATENT APPLICATION: 0502235.5



電子遙控窗簾機

ELECTRONIC REMOTE CONTROL CURTAIN SYSTEM

品味現代生活，遙控“太陽”光線，創造生活經典新時代！
MODERN LIFE STYLE！ THE REMOTE CONTROL OF“ SOLAR” GLORY！
A CLASSICAL PATTERN FOR FUTURE TIME！

“太陽”窗飾系統
“SOLAR” CURTAIN SYSTEM



公司簡介

本公司成立於1980年,乃香港特區政府房屋局, 各大地產、建築公司之認可供應和承裝商。專業從事“電動窗簾機”的開發、生產和銷售, 其主要產品有電子遙控窗簾機、垂簾機、百頁簾機、羅馬簾機和天棚簾機等。

上述產品適宜安裝於各式各樣窗戶, 不論直型或弧型窗均可, 最配合; 星級賓館、酒樓、辦公室、影劇院、會議室和各大小家庭。

本公司多項產品已取獲歐洲共同市場安全標準CE、GS、VDE 嘜, 美國、加拿大安全標準UL、CSA, 嘜, 香港安全標準HOKLAS 嘜和中國安全標準CCC 嘜。產品中的電動機和零配件均由外國進口, 固產品之性能可靠, 品質優良, 所以大受歐、美、澳洲、東南亞等國家歡迎。本公司并承擔所有產品售後一年免費保修, 終生維護。

本公司於中國廣東省自置廠房4千多平方米, 有充足機械設備, 優秀的管理和工程人員, 并自設研究開發部。另雇用200多名優質生產人員, 除生產本公司所設計的產品外, 亦生產顧客設計的產品。另產品已申請中國及英國專利認證。



More than 20 years in design, production and sells experience of “Electrical Curtain System”, we specialize in the field of Electronic Remote Control Curtain System, Roller Blind, Vertical Blind, Roman Shade and Sky Shade.

The above products are used for all kinds of window openings such as straight and/or curved on plan. It is ideal for living and dining rooms of common residences, and/or hotels, restaurants, offices, theatres, conference rooms etc.

A range of products come with a good safety approval of CE GS VDE mark for European Common Market, UL CSA mark for USA, HOKLAS for Hong Kong and CCC For China.

To ensure the good quality of our products, electrical motor together with main accessories are imported from foreign countries. That is the reason of our company to win the reputation in Europe, USA and Asia countries. We will warrant the quality of our products for the product life.

Our own 4,000 square meters factory located in Guangdong, China and equipped with excellent engineering staffs, management staffs and machinery can provide a huge production capacity, very competitive price, prompt delivery and good quality directly. Please contact us for further information and OEM is welcome. We have applied the patent pending in Uk and China for our products

應用於星級酒店 IDEAL FOR STAR CLASS HOTELS

電子遙控窗簾機

特點:

1. 電動機和主要配件均由外國進口。
2. 安裝方便，機箱與軌道分開包裝，便于運輸節省成本，另配合ROM影碟說明，任何客人均會安裝。
3. 多種控制方式：
 - a. 手控、紅外線遙控、無線 (FM) 遙控
 - b. 可單軌、雙軌分別控制
 - c. 離合方式，可實現人手拉動或電動開關窗簾，最適宜酒店、賓館客戶。
4. 安全的電路設計，具有過流保護，過重保護、過熱保護和空轉保護，可任意方向任意位置控制；適合單開，雙開方式。
5. 獨特軌道設計，可實現隨意長度，隨意彎曲成不同形狀。(最少彎曲半徑 150mm)
6. 家庭，賓館，酒樓，寫字樓，影劇院，會議室最理想的新型裝飾電器。
7. 技術參數：
 - a. 型號：RCT
 - b. 額定電壓：220V/50HZ, 110V/60HZ
 - c. 額定功率：25W
 - d. 遙控距離：12M
 - e. 拉簾速度：6sec/m
 - f. 最大拉簾重量：80Kgs



酒店客房 Hotel's room

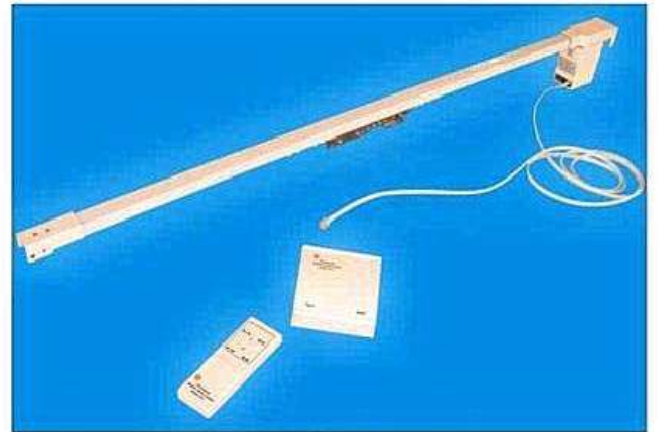

直型路軌 Straight curtain track

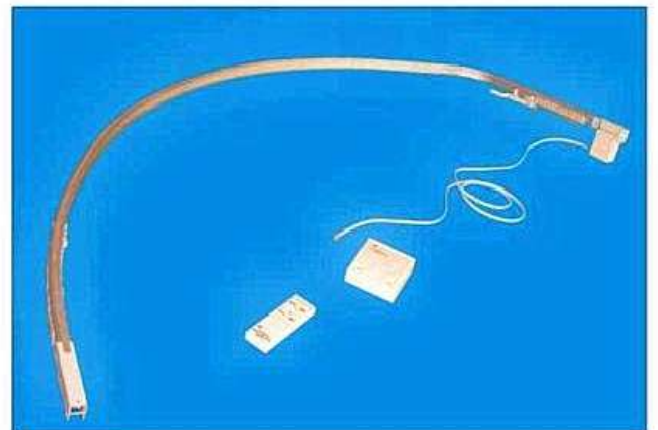

彎曲路軌 Curve curtain track

Electronic Remote Control Curtain System

Distinct Features:

1. Motor and main parts are imported from foreign countries.
2. Package of control unit and aluminium track are separated for handy transportation and cost saving. A CD-ROM of Owner's Manual is enclosed to simplify the installation of this product.
3. Multi-control pattern allows:
 - a. Handheld switch control, infrared remote control and FM remote control
 - b. Single or dual track's control respectively.
 - c. Clutch device to manual operation or electrical operation especially for hotel use.
4. A good safety circuit design protect over current over load, over heat and no loading (steel wire is broken) and allows to operate in a desirable distance and position for one way and two way direction.
5. A unique shape of aluminium track is ideal for variation of length and bent to different curve (radius not less than 150mm)
6. Excellent for use in common residences and/or hotels, restaurants, offices, theatres and conference rooms etc.
7. Technical Specification:
 - a. Model: RCT
 - b. Voltage: 220V/50Hz, 110V/60Hz
 - c. Power Consumption: 25W
 - d. Maximum Remote Control Distance: 12M
 - e. Opening and Closing Time: 6sec/M
 - f. Maximum Curtain Weight: 80kgs

“太陽牌”路軌可以彎曲成以下形狀
"SOLAR BRAND" CURTAIN TRACK CAN BE BENDED TO THE FOLLOWING SHAPES

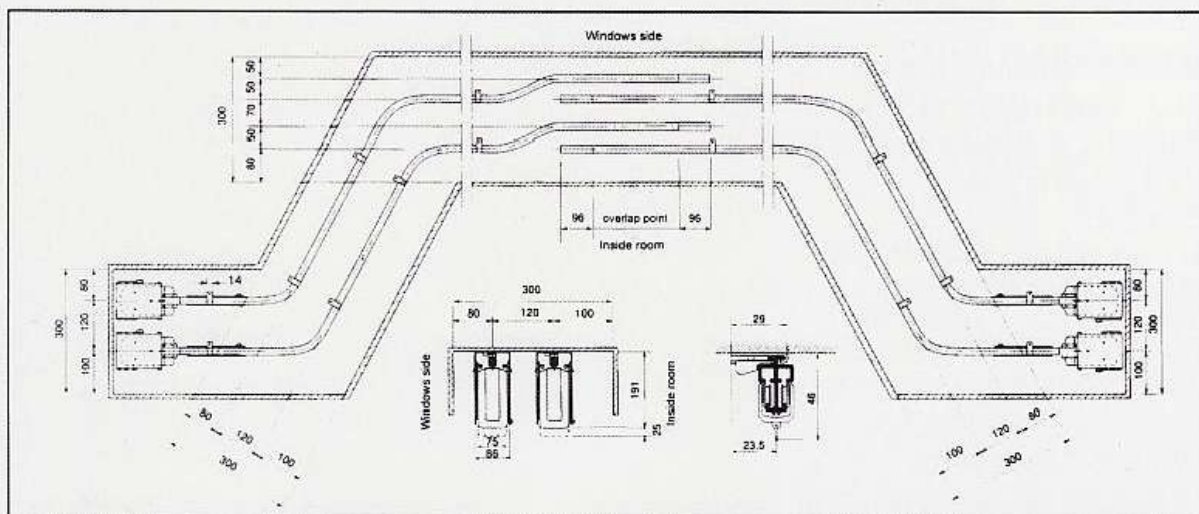

“拱型” Arcaded shape

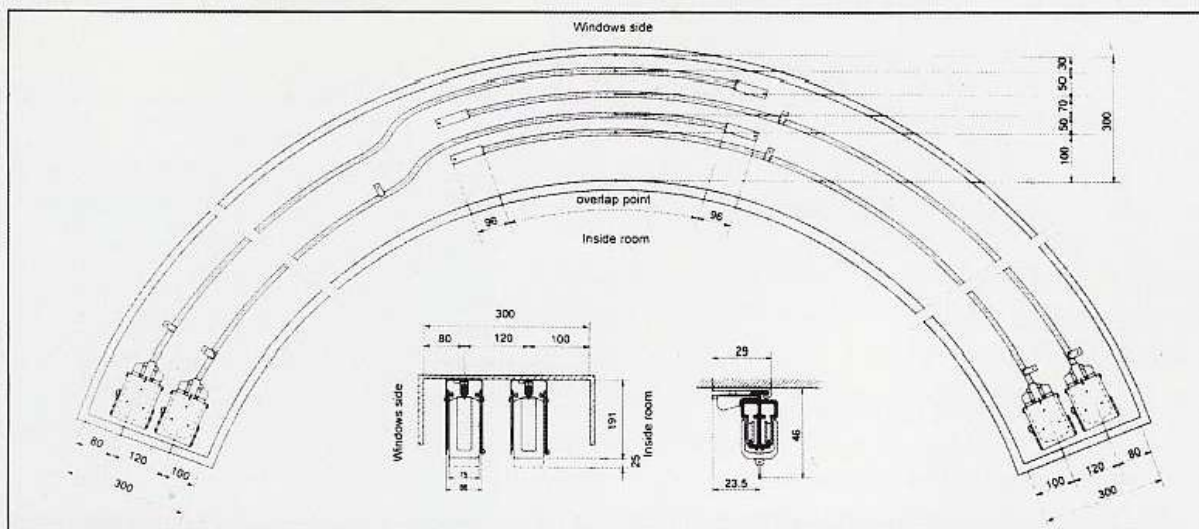

“圓弧型” Dome shape

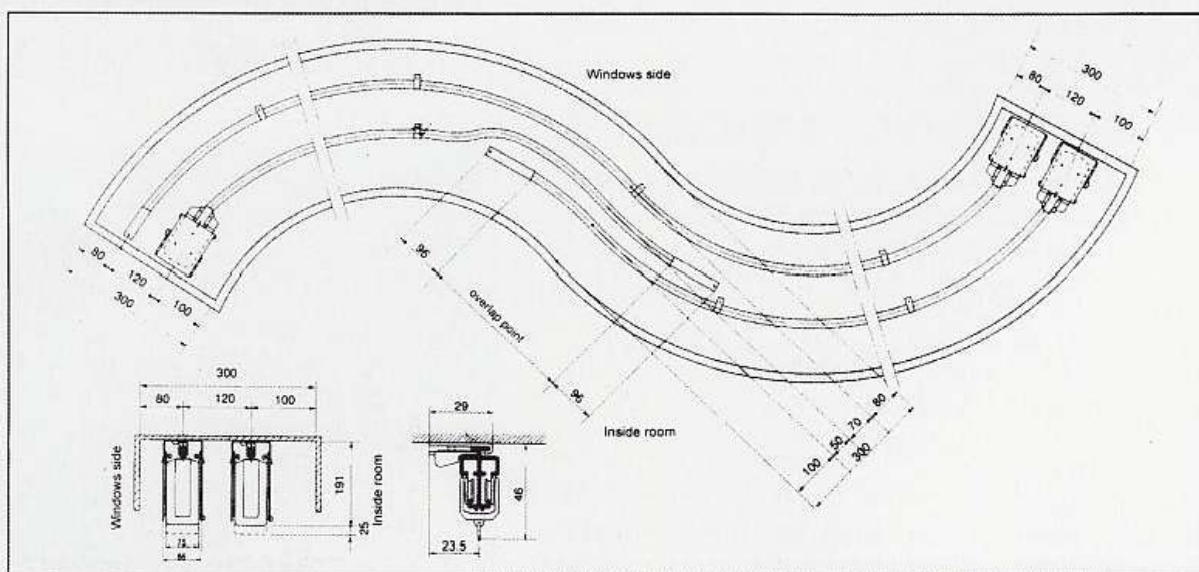

“S字型” S SHAPE

停電可拉電動窗簾機

NEW MODEL: WITH A BUILD-IN ELECTROMAGNETIC CLUTCH



太陽牌新型停電可拉電動窗簾機

1. 現時在市場的窗簾多為手拉式，比較先進的為電動機帶動的電動式。手拉式多為家庭使用，窗簾的體積和載重量較小，電動式拉動力較大，可拉動較重的窗簾，主要用于高級賓館；酒店；別墅；辦公大樓。手拉式不能拉動較大，較重的窗簾；而電動式拉動的電動窗簾機，因與窗簾軌道的牙輪緊扣的關係，一旦停電或發生機器故障，便無法使用開合窗簾
2. 本產品是一種既可以手動又可以電動開合裝置的電動窗簾機
3. 本新型停電可拉電動窗簾是針對目前使用的手拉式，不能拉較大，較重的窗簾，而電動式因一旦遇到停電或機械故障做成無法使用窗簾的問題。本公司為著廣大客戶的需要，特別研制此款新型停電可拉電動窗簾機，此電機拉力強大，完全解決了手拉的問題，又完全解決一般電動機結構所存在的問題

SOLAR BRAND ELECTRONIC REMOTE CONTROL CURTAIN SYSTEM NEW MODEL: WITH A BUILD-IN ELECTROMAGNETIC CLUTCH

The present new model provides an electromagnetic clutch linking to the motor and the curtain traction device and arranged so that, when the motor operates the electromagnet clutch links the motor to the rotation means of the curtain traction device so that the said rotation mean is rotated and when the motor does not operate the electromagnetic clutch does not link the motor to the rotation means of the curtain traction device

To draw the curtain are either by hand or by electricity. This new model is suitable especially for hotel, villa, restaurant and office.

停電可拉電動窗簾機與簡易電動窗簾機體積大小對比

停電可拉電動窗簾機	簡易電動窗簾機
體積: 43×66×113mm	體積: 43×60×74mm
重量: 480g	重量: 278g

本公司生產測試數據和在展覽會作示範的拉動力為100公斤，本公司所定的安全系數為60公斤

Comparison of clutch system and general use system:

Clutch System	General Use System
Size: 43×66×113mm	Size: 43×60×74mm
Weight: 480g	Weight: 278g

The testing factor of a drawing strength in the factory and the demonstrations in the fairs are 100Kgs, Our recommended drawing strength are 60kgs



電動卷簾、垂直簾、百葉簾

ELECTRICAL ROLLER BLIND, VERTICAL BLIND, VENETIAN BLIND

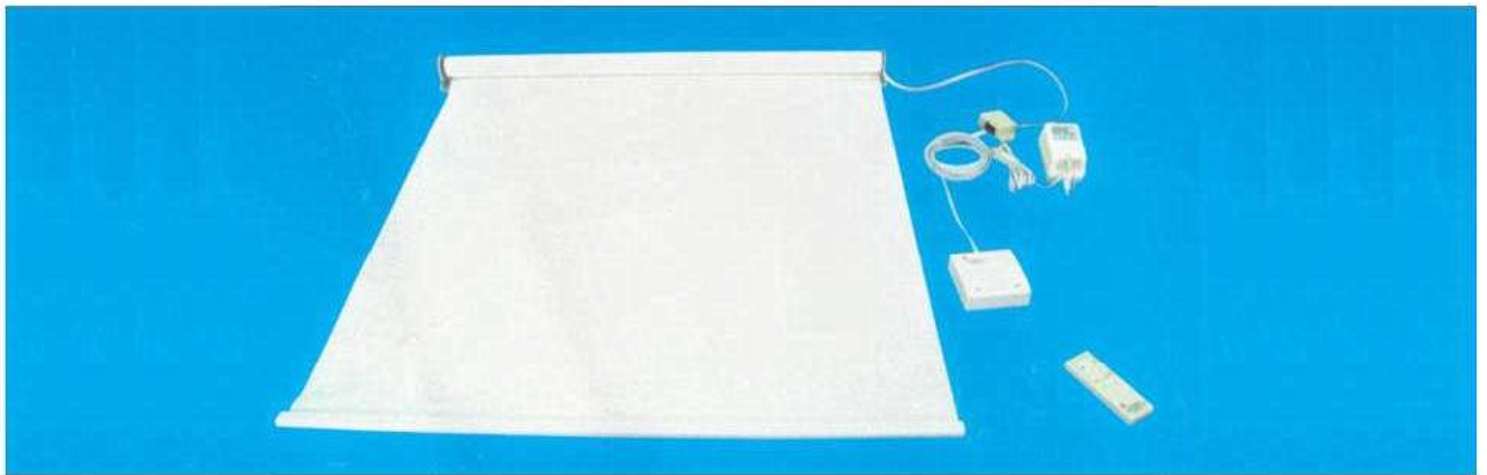

電動卷簾 Electrical roller blind

電動卷簾

採用優質進口直流電機，具備噪音小，運轉平穩，外形美觀，性能穩定，應用先進，方便電子調控行程，便於安裝后隨時再進行調節，不像目前使用交流管狀電機，必需於電機支架上調教行程，一旦將電機安裝於高處后，則較難再次調教。

Electrical Roller Blind

The features of a good quality imported DC motor are smooth turning, quiet noise, durable and reliable functions and particular as applied a handy and advanced technology of electronic adjuster. Which can control the limited distance of turning of motor in a handy place and position and not as the known AC cyclinder motor which must be adjusted on the motor shelf itself and quite inconvenience once the motor was hung on a high ceiling.



休閒間 Leisure Room

天篷簾 - SKY SHADE

說明：

1. 進口直流電機
2. 先進電子調控行程
3. 技術參數：
 額定電壓：220V/50HZ, 110V/60HZ
 額定功率：25W
 遙控距離：12M
 拉簾速度：6 sec/m
 最大拉簾重量：30 kgs

Specification:

1. Imported DC motor
2. Advanced technology of electronic adjuster for limited distance of turning
3. Voltage: 220V/50HZ, 110V/60HZ.
4. Power Consumption: 25W
5. Maximum Remote Control Distance: 12M
6. Opening & Closing Time: 6 sec/M
7. Maximum Curtain Weight: 30 kgs



天篷例 Sky shade model

貫例 EXAMPLE



商業洽談室 Business's conference room



展覽廳 Exhibition Hall



中西式餐廳 Restaurant



客廳 Living Room



太陽牌
Solar Brand

“太陽”光輝，點綴生活千分美
THE "SOLAR" GLORY DECORATES THE PERFECT LIFE!

“太陽”窗飾系統
"SOLAR" CURTAIN SYSTEM



金洋實業有限公司
東莞太陽塑膠五金製品有限公司

香港九龍葵涌大連排道172-180號金龍工業中心第三期二樓C座

電話: (+852) 2424 7485, 2428 3296 傳真: (+852) 2480 3346

中國廠址: 廣東省東莞市長安鎮上角管理區上興路17號

電話: (+86) 769-85543599 傳真/電話: (+86) 769-823-823-93

Website: <http://www.kamyeung.com>

Email: kamyeung1990@gmail.com

kamyeung1980@yahoo.com.hk

taiyang1980@gmail.com

taiyang_08@126.com

KAM YEUNG COMPANY LIMITED

FLAT C, 2/F., BLOCK 3, GOLDEN DRAGON INDUSTRIAL CENTRE, 172-180 TAILIN

PAI ROAD, KWAI CHUNG, N.T., KOWLOON, HONG KONG

TEL: (+852) 2424 7485, 2428 3296 FAX: (+852) 2480 3346

Website: <http://www.kamyeung.com>

Email: kamyeung1990@gmail.com

kamyeung1980@yahoo.com.hk

taiyang1980@gmail.com

taiyang_08@126.com



ELECTRIC REMOTE CONTROL CURTAIN SYSTEM

OPEN & CLOSE CURTAIN • ROLLER (ROMAN) BLIND
VERTICAL BLIND • VENETIAN BLIND • SKYLIGHT SHAPE... ETC.
INFRARED or RF CONTROL • **HOME AUTOMATION COMPATIBLE**



"D.I.Y."

OPEN & CLOSE CURTAIN

- ✓ UP TO 6 METERS OR MORE
- ✓ SUPPORTS CURTAINS WEIGHTING 100kgs OR MORE
- ✓ SUPER QUIET 45dBA ONLY
- ✓ OPEN / CLOSE BY ELECTRICITY OR MANUAL (POWER DOWN)



- * Unfold to 2, 3, 4, 5, 6 meter or any length within 6m in 1 minute and ready for fixing on ceiling/wall.
- * Folds up to one meter for storage & transportation.
- * All tracks and accessories are packed in a carton box with handle, making it easy to carrying.
- * Able to sell in department / chain stores

Our products are used for all kinds of window openings such as **straight** and/or **curved** on plan. It is **ideal for living and dining rooms** of common **residences** and/or **hotels, restaurants, offices, theatres, conference rooms...** etc. At **affordable price** it can fit into almost any family budget. **O.E.M. is welcome.**

Distinct Feature:

- **Infrared** or **RF** control.
- Electromagnetic clutch device for **electrical operation** or **manual operation** ESPECIALLY for **hotel, villa, restaurant** and **office**.
- No limited switch, **easily fixing** and installation.
- One way or **two ways direction**.
- Stops at once by incidental interference.
- **Safety circuit design** protect against over-current, over-load, over-heat and no loading (when stainless steel wire is broken).
- Puts an end to messy cords and chains, no more such risks for children.

金洋實業有限公司 KAM YEUNG COMPANY LIMITED

FLAT C, 2/F., BLOCK 3, GOLDEN DRAGON INDUSTRIAL CENTRE,
172-180 TAI LIN PAI ROAD, NEW TERRITORIES, HONG KONG
TEL: (852) 24283296, 24247485 FAX: (852) 24803346

EMAIL: kamyung1990@gmail.com / kamyung1980@yahoo.com.hk

WEBSITE: <http://www.kamyung.com>



ROLLER BLIND / ROMAN BLIND



VENETIAN BLIND

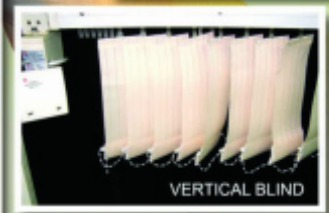

VERTICAL BLIND



SKYLIGHT SHAPE



CURVED TRACK

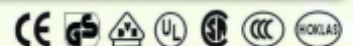



STAINLESS STEEL ROTATIONAL DRYING LINES DEVICE (Automatic Retraction)

Model : KY430



- Automatic Retractable Function.
- Designed for Indoor & Outdoor Use.
- High Durability Even under Strong Sunshine.
- Heavy Duty for Large Quantity of Laundries.
- Superior Quality.
- Easy to Operate & Store.

Tube Diameter: 76.2 mm
Tube Length: 406 mm
Nylon Line Diameter: Approx. 3 mm
Nylon Line Length: Approx. 6 Meters (Max. extension)
Net Weight: Approx 1.2 Kg.

KAM YEUNG COMPANY LTD.

FLAT C, 2/FL., BLOCK 3, GOLDEN DRAGON IND. CENTRE,
172-180 TAI LIN PAI RD., KWAI CHUNG, N.T. HONG KONG.
TEL: (852) 2428 3296, 2424 7485 FAX: (852) 2480 3346

EMAIL: kamyeung1990@gmail.com, kamyeung1980@yahoo.com.hk

WEBSITE: <http://www.kamyeung.com>



金洋實業有限公司

KAM YEUNG COMPANY LIMITED

EEZEE-DRY®

太陽牌活動晾衫架
Solar Brand Drying Rack

專營：鋁質不鏽鋼製品、活動晾衫架
各款信箱、保安門閘、家庭用品
遙控電動窗簾

易曬牌活動晾衫架
Aluminium Drying Rack

Your Ref:

Our Ref:

Date:

產品圖紙

Shop Drawing

ADDRESS : FLAT C, 2/FL., BLOCK 3, GOLDEN DRAGON INDUSTRIAL CENTRE,
172-180 TAI LIN PAI ROAD, KWAI CHUNG, N. T., KOWLOON, HONG KONG
WEBSITE : <http://www.kamyeung.com>

E-MAIL: kamyeung1980@yahoo.com.hk
kamyeung1990@gmail.com

TEL: 852-2428 3296, 2424 7485
FAX: 852-2480 3346

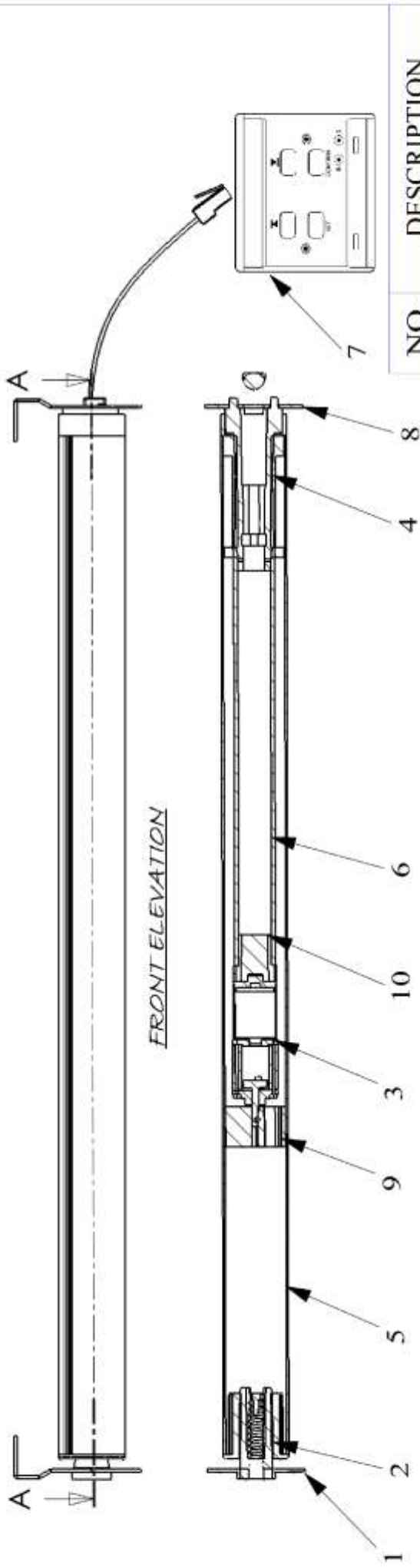

FRONT ELEVATION

PERSPECTIVE VIEW
 -FROM ABOVE, ONE SIDE & ONE END-

PROFILE A-A

NO.	DESCRIPTION
1	CEIL / WALL MOUNT BRACKET
2	REAR BUSHING
3	MOTOR
4	TRANSMISSION & FIXED BUSHING
5	φ32MM ALUM. TUBE
6	FIXED TUBE FOR MOTOR
7	WALL MOUNT CONTROL BOARD
8	CEILING & WALL MOUNT BRACKET
9	MOTOR SHAFT SET
10	MOTOR MOUNTING BRACKET

KAM YEUNG COMPANY LIMITED

TITLE:
ELECTRIC ROLLER BLIND
ASSEMBLING DRAWING

DRAWN	NAME	DATE
CHECKED	LIN	07/12/05
ENG APPR.	Sunny	2006/12/21
MFG APPR.		
Q.A.		
COMMENTS:		

UNLESS OTHERWISE SPECIFIED:	
DIMENSIONS ARE IN MM	
TOLERANCES:	
FRACTIONAL ±	
ANGULAR/MACH ± BEND ±	
TWO PLACE DECIMAL ±	
INTERPRET GEOMETRIC TOLERANCING PER:	
MATERIAL:	
FINISH:	
NEXT ASSY	USED ON
APPLICATION	
DONOT SCALE DRAWING	

PROPRIETARY AND CONFIDENTIAL

THE INFORMATION CONTAINED IN THIS DRAWING IS THE SOLE PROPERTY OF <KAM YEUNG COMPANY LIMITED>. ANY REPRODUCTION IN PART OR AS A WHOLE WITHOUT THE WRITTEN PERMISSION OF <KAM YEUNG COMPANY LIMITED> IS PROHIBITED.

SIZE: DWG. NO. REV

A3 TY-0920061221-1

SCALE: WEIGHT: SHEET OF 1



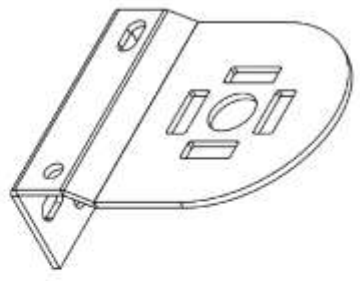
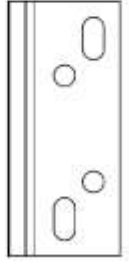
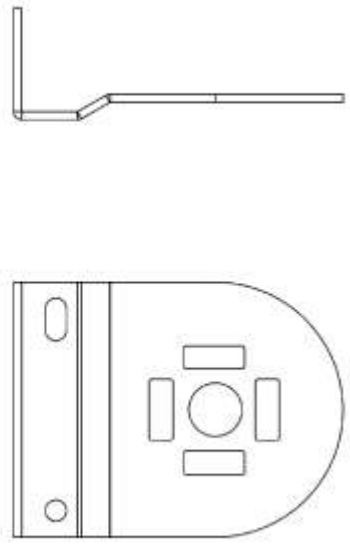

CEILING / WALL MOUNT BRACKET



ALUMINIUM TUBE

UNLESS OTHERWISE SPECIFIED, DIMENSIONS ARE IN MILLIMETERS		FINISH		DIMENSIONS AND WEIGHT GROUP		DO NOT SCALE DRAWING		REVISION	
DESIGNER	DATE	DESCRIPTION	DATE	NO.	DESCRIPTION	NO.	DESCRIPTION	NO.	DESCRIPTION
BRANK	LIN	DATE	07/12/05						
CHK'D	Sunny	DATE	30/01/01						
APP'D									
ENG. NO.									
Q.A.									
				MATERIAL					
				WEIGHT					
				SCALE 1:1					
				SHEET 1 OF 1					

KAM YEUNG COMPANY LIMITED

ELECTRIC ROLLER BLIND:
DRAWINGS OF ALUMINIUM TUBE &
CEILING / WALL MOUNT BRACKET

A3

TY-0920061221-2

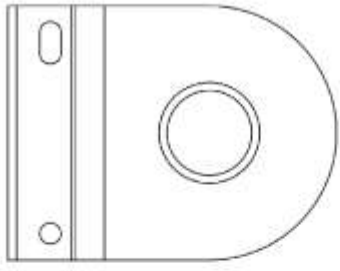
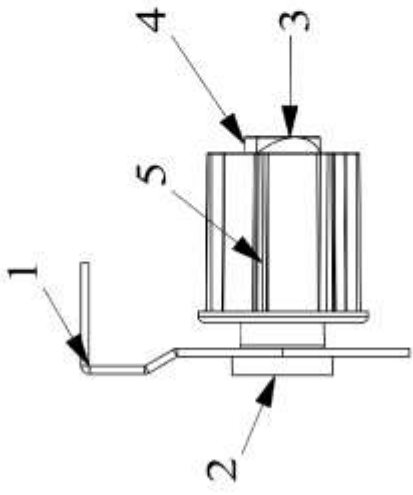

**1--CEILING / WALL MOUNT
BRACKET**

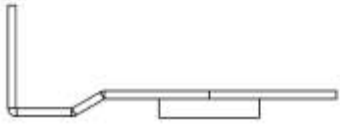

**2--BEARING
NO. 628/8**



3--SPRING



4--REAR EXTENSION SHAFT



5--REAR BUSHING

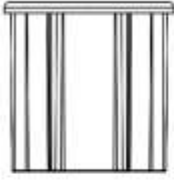

CHECK OFF REVISE CHECKED DRAWING NAME IN CAPITAL LETTERS SUBTRACT DIMENSIONS TOLERANCES HATCH ANGLE BAR		TITLE DATE	CHECKED DATE	DRAWN DATE
LIN SUMMY		07/12/05 2004-12-21	07/12/05 2004-12-21	07/12/05 2004-12-21
WHO D/A		MATERIAL	WEIGHT	SCALE

DO NOT SCALE DRAWING	REVISION
KAM YEUNG COMPANY LIMITED	
B111 ELECTRIC ROLLER BLIND DRAWINGS OF CEILING / WALL MOUNT BRACKET & ACCESSORIES	
2004-12-21 TY-0920061221-3	A3 SHEET 1 OF 1

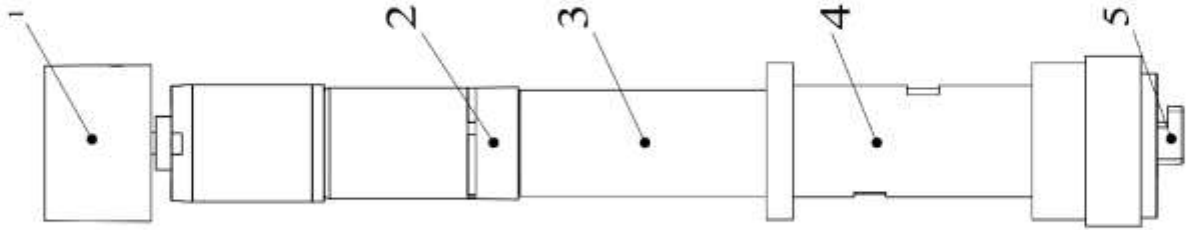

Technical drawings of the 1-Motor Shaft Set and 2-Motor Mounting Bracket. The 1-Motor Shaft Set is shown in two views: a top view and a side view. The 2-Motor Mounting Bracket is shown in a side view.

1--MOTOR SHAFT SET 2--MOTOR MOUNTING BRACKET

Technical drawings of the 3-Motor Fixed Tube. It is shown in two views: a top view and a side view.

3--MOTOR FIXED TUBE

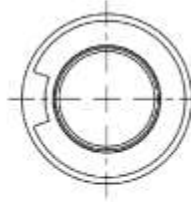

4--TRANSMISSION BUSHING

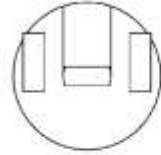
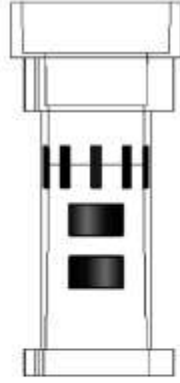

5--FIXED BUSHING

SENSOR

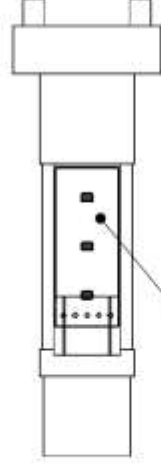

UNLESS OTHERWISE SPECIFIED,
DIMENSIONS ARE IN MILLIMETERS.
TOLERANCES:
LINEAR: ANGULAR:

DATE AND
DRAWN BY
(CODE)

DO NOT SCALE DRAWING

REVISION

KAM YEUNG COMPANY LIMITED

REV:

**ELECTRIC ROLLER BLIND:
MOTOR ASSEMBLING DRAWING**

DWG NO. TY-0920061221-4

A3

SHEET 1/1

WPSHP

4

3

2

1

8

7

6

5

4

3

2

1

A

B

C

D

E

F



1	SET READING POINT
2	LOCATION READING POINT 2
3	LOCATION READING POINT 1

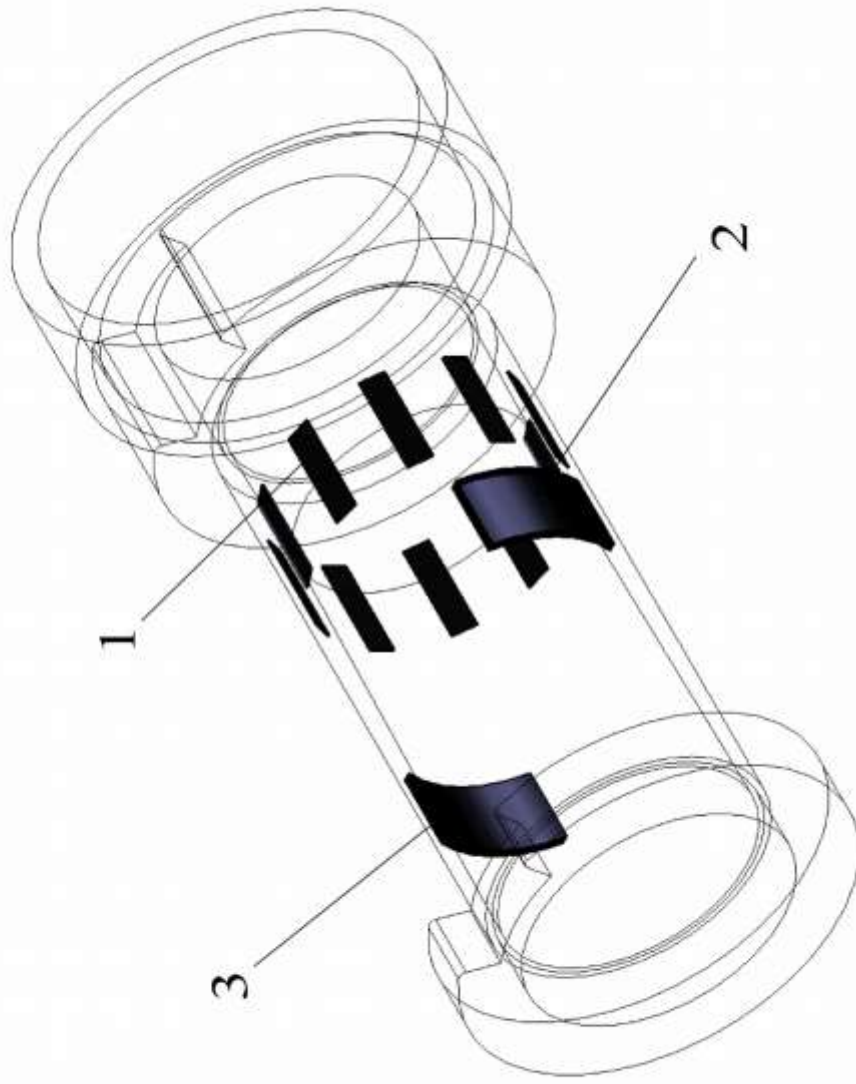

UNLESS OTHERWISE SPECIFIED:		DRAWN	NAME	DATE	KAM YEUNG COMPANY LIMITED
DIMENSIONS ARE IN INCHES		CHECKED	ZHANG	13/08/05	
TOLERANCES: ±0.05		ENG APPR.	Sunny	2006/12/21	TITLE:
FRACTIONAL: 2		MFG APPR.			ELECTRIC ROLLER BLIND
ANGULAR-MACH: BEND: 2		Q.A.			TRANSPARENT TRANSMISSION SHAFT
THREE PLACE DECIMAL: 2		COMMENTS:			DRAWING
MATERIAL: TRANSPARENT ABS					SIZE
FINISH					A4
DO NOT SCALE DRAWING					DWG. NO.
NEXT ALLY		USED ON			TY-0920061221-5
APPLICATION					REV
PROPRIETARY AND CONFIDENTIAL THE INFORMATION CONTAINED IN THIS DRAWING IS THE SOLE PROPERTY OF KAM YEUNG COMPANY LIMITED. ANY REPRODUCTION IN PART OR AS A WHOLE WITHOUT THE WRITTEN PERMISSION OF KAM YEUNG COMPANY LIMITED IS PROHIBITED.					SCALE: 1:1
					WEIGHT: 9.94 grams
					SHEET 1 OF 1

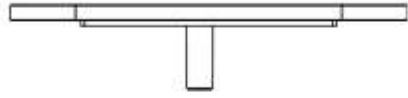
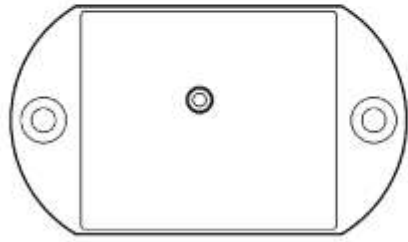
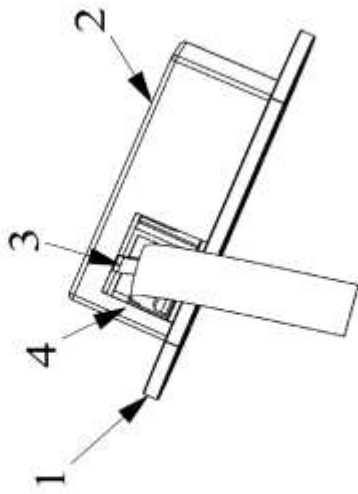

1--ABS CIRCUIT BOARD BOTTOM

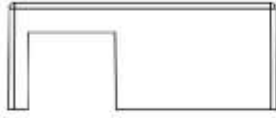
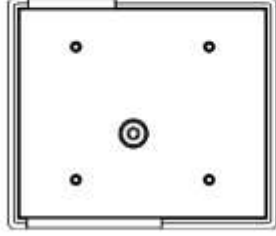

2--ABS COVER



3--RJ45 PLUG

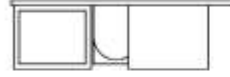
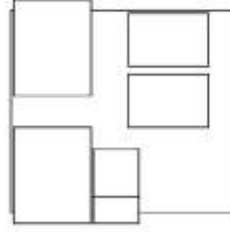

4--CIRCUIT BOARD

PLEASE OBSERVE DIMENSIONS
AND TOLERANCES IN ALL PARTS
UNLESS OTHERWISE SPECIFIED
UNITS: MILLIMETER
TOLERANCES:
FRACTIONAL
DECIMAL

FIG. NO.

NO.	NAME	QUANTITY	DATE
1	LIN		07/12/08
2	Sunny		2008/12/27
3			
4			
5			
6			
7			
8			
9			
10			

DATE AND
SCALE DRAWING

SCALE DRAWING

REVISION

KAM YEUNG COMPANY LIMITED

TITLE

**ELECTRIC ROLLER BLIND:
CONTROL BOARD DRAWING**

DWG NO.

TY-0920061221-6

A3

MATERIAL

WEIGHT

SCALE: 1:1

SHEET 1 OF 1



金洋實業有限公司

KAM YEUNG COMPANY LIMITED

EEZEE-DRY®

太陽牌活動晾衫架
Solar Brand Drying Rack

專營：鋁質不鏽鋼製品、活動晾衫架
各款信箱、保安門閘、家庭用品
遙控電動窗簾

易曬牌活動晾衫架
Aluminium Drying Rack

Your Ref:

Our Ref:

Date:

各項証書
Certificates

ADDRESS : FLAT C, 2/FL., BLOCK 3, GOLDEN DRAGON INDUSTRIAL CENTRE,
172-180 TAI LIN PAI ROAD, KWAI CHUNG, N. T., KOWLOON, HONG KONG
WEBSITE : <http://www.kamyeung.com>

E-MAIL: kamyeung1980@yahoo.com.hk
kamyeung1990@gmail.com

TEL: 852-2428 3296, 2424 7485
FAX: 852-2480 3346



ELECTRONIC TECHNOLOGY SYSTEMS
DR. GENZ GMBH

COMPETENT BODY / ACCREDITED TEST HOUSE

EC DECLARATION OF CONFORMITY

This certifies that the following designated product

ELECTRONIC REMOTE CONTROL CURTAIN SYSTEM
MODEL NO. : RCT-3

(Product identification)

complies with the essential protection requirements of Council Directive 89/336/EEC on the approximation of the laws of the Member States relating to electromagnetic compatibility.

This declaration applies to all specimens manufactured in accordance with the attached manufacturing drawings which form part of this declaration.

Assessment of compliance of the product with the requirements relating to electromagnetic compatibility was based on the following standards:

EN 50081-1 /1992: EN 55014, EN 61000 - 3 - 2 / -3,
EN 50082-1 /1997: EN 55014-2 (EN 61000-4-2 / -3/ -4/ -5/ -6/ -11)

(Identification of regulations / standards)

This declaration is the responsibility of the manufacturer / importer

KAM YEUNG CO. LTD
FLAT C,D 2/F, BLOCK 3, GOLDEN DRAGON IND. CENTRE 172-180, TAI LIN PAI
Rd.,
KWAI CHUNG,

(Name / Address)



THIS DOC IS ONLY VALID IN CONNECTION WITH TEST REPORT NUMBER : H1M2010694659-E-16

MANUFACTURER / IMPORTER

TEST LABORATORY

This is the result of test, that was carried out from the submitted type-samples of a product in conformity with the specification of the respective standards.
The certificate holder has the right to fix the CE-mark for EMC on the product complying with the inspection sample.

July 16, 2001

(Date)

Dr. Genz

Dr. Genz

(Date)



(Surname, forename)

(Company stamp)



ELECTRONIC TECHNOLOGY SYSTEMS DR. GENZ GMBH

STROBELWER STRASSE 77C, D-11526 REEDENWALDE II, BERLIN, GERMANY, PHONE + 49-33631-88900 FAX + 49-33631-88866



ELECTRONIC TECHNOLOGY SYSTEMS
DR. GENZ GMBH
COMPETENT BODY ACCREDITED TEST HOUSE

CERTIFICATE OF CONFORMITY

EU EMC - DIRECTIVE 89/336/EEC -

This certifies that the following designated product

ELECTRONIC REMOTE CONTROL CURTAIN SYSTEM WITH CLOCK
MODEL No. : RCT-3C

(Product identification)

complies with the essential protection requirements of Council Directive 89/336/EEC on the approximation of the laws of the Member States relating to electromagnetic compatibility.

This certificate is awarded following tests carried out on samples of the product referred to above. Assessment of compliance of the product with the requirements relating to electromagnetic compatibility was based on the following standards :

EN 55014-1:2000+A1 :2001+A2 :2002, EN 55022 :1998+A1 :2000+A2 :2003
EN 55014-2:1997+A1 :2001, EN 61000-3-2 :2000, EN 61000-3-3 :1995+A1 :2001

(Identification of regulations / standards)

This certificate is issued for

KAM YEUNG CO., LTD.
FLAT C, D, 2/F., BLOCK 3, GOLDEN DRAGON IND. CENTRE, 172-180 TAI LIN PAI ROAD
KWAI CHUNG, N.T., HONG KONG

(Name / Address)

THE CERTIFICATION IS VALID ONLY IN ACCORDANCE WITH THE TEST REPORT NO. ETR2007-01663-E-11
THE CERTIFICATION IS VALID ONLY IF THE PRODUCT IS MANUFACTURED IN ACCORDANCE WITH THE TEST REPORT

GS LVD LVD-MARK FCC GEM UMS CE-MARK SAR RADSO CB EMC DECT WLAN 3G Bluetooth B2TE



This is the result of tests carried out on three samples of the product referred to above which were submitted for testing in accordance with the specifications for the respective standards. The certificate holder has the right to file the ETS-MARK which shows the EMC approval only each individual product in the series to which the respective sample belongs, provided that the product is manufactured in accordance with the test report.



August 23, 2007

(Date)

Dr. Genz

ERN2007-01663

Dr. Genz Testlabor für Systeme Dr. Genz GmbH

Am Markt 1a, 40477 Düsseldorf, Germany, Tel: +49 210 3000000 Fax: +49 210 3000000



金洋實業有限公司

KAM YEUNG COMPANY LIMITED

EEZEE-DRY®

太陽牌活動晾衫架
Solar Brand Drying Rack

專營：鋁質不鏽鋼製品、活動晾衫架
各款信箱、保安門閘、家庭用品
遙控電動窗簾

易曬牌活動晾衫架
Aluminium Drying Rack

Your Ref:

Our Ref:

Date:

工作記錄：相片

Job Reference (Photos)

ADDRESS : FLAT C, 2/FL., BLOCK 3, GOLDEN DRAGON INDUSTRIAL CENTRE,
172-180 TAI LIN PAI ROAD, KWAI CHUNG, N. T., KOWLOON, HONG KONG
WEBSITE : <http://www.kamyeung.com> E-MAIL: kamyeung1980@yahoo.com.hk
kamyeung1990@gmail.com

TEL: 852-2428 3296, 2424 7485
FAX: 852-2480 3346



金洋實業有限公司

KAM YEUNG COMPANY LIMITED

EEZEE-DRY®

太陽牌活動晾衫架
Solar Brand Drying Rack

專營：鋁質不鏽鋼製品、活動晾衫架
各款信箱、保安門閘、家庭用品
遙控電動窗簾

易曬牌活動晾衫架
Aluminium Drying Rack

Your Ref:

Our Ref:

Date:

Job Reference (Photos)

Supply & Install of Roller Blind Systems at Bossini Group, Kowloon West District, H. K.



ADDRESS : FLAT C, 2/FL., BLOCK 3, GOLDEN DRAGON INDUSTRIAL CENTRE,
172-180 TAI LIN PAI ROAD, KWAI CHUNG, N. T., KOWLOON, HONG KONG
WEBSITE : <http://www.kamyeung.com> E-MAIL: kamyeung1980@yahoo.com.hk
kamyeung1990@gmail.com

TEL: 852-2428 3296, 2424 7485
FAX: 852-2480 3346



金洋實業有限公司

KAM YEUNG COMPANY LIMITED

EEZEE-DRY®

太陽牌活動晾衫架
Solar Brand Drying Rack

專營：鋁質不鏽鋼製品、活動晾衫架
各款信箱、保安門閘、家庭用品
遙控電動窗簾

易曬牌活動晾衫架
Aluminium Drying Rack

Your Ref:

Our Ref:

Date:

Job Reference (Photos)

Supply & Install of Roller Blind Systems at 38/F., World Trade Centre, Wan Chai, H. K.



ADDRESS : FLAT C, 2/FL., BLOCK 3, GOLDEN DRAGON INDUSTRIAL CENTRE,
172-180 TAI LIN PAI ROAD, KWAI CHUNG, N. T., KOWLOON, HONG KONG
WEBSITE : <http://www.kamyeung.com> E-MAIL: kamyeung1980@yahoo.com.hk
kamyeung1990@gmail.com

TEL: 852-2428 3296, 2424 7485
FAX: 852-2480 3346



金洋實業有限公司

KAM YEUNG COMPANY LIMITED

EEZEE-DRY®

太陽牌活動晾衫架
Solar Brand Drying Rack

專營：鋁質不鏽鋼製品、活動晾衫架
各款信箱、保安門閘、家庭用品
遙控電動窗簾

易曬牌活動晾衫架
Aluminium Drying Rack

Your Ref:

Our Ref:

Date:

Job Reference (Photos)

Supply & Install of Roller Blind Systems at 深圳聯泰大廈 23/F



ADDRESS : FLAT C, 2/FL., BLOCK 3, GOLDEN DRAGON INDUSTRIAL CENTRE,
172-180 TAI LIN PAI ROAD, KWAI CHUNG, N. T., KOWLOON, HONG KONG
WEBSITE : <http://www.kamyeung.com> E-MAIL: kamyeung1980@yahoo.com.hk
kamyeung1990@gmail.com

TEL: 852-2428 3296, 2424 7485
FAX: 852-2480 3346



金洋實業有限公司

KAM YEUNG COMPANY LIMITED

EEZEE-DRY®

太陽牌活動晾衫架
Solar Brand Drying Rack

專營：鋁質不鏽鋼製品、活動晾衫架
各款信箱、保安門閘、家庭用品
遙控電動窗簾

易曬牌活動晾衫架
Aluminium Drying Rack

Your Ref:

Our Ref:

Date:

Job Reference (Photos)

Supply & Install of Open & Close Curtain Systems at Regent Hotel, Shanghai, China



ADDRESS : FLAT C, 2/FL., BLOCK 3, GOLDEN DRAGON INDUSTRIAL CENTRE,
172-180 TAI LIN PAI ROAD, KWAI CHUNG, N. T., KOWLOON, HONG KONG
WEBSITE : <http://www.kamyeung.com> E-MAIL: kamyeung1980@yahoo.com.hk
kamyeung1990@gmail.com

TEL: 852-2428 3296, 2424 7485
FAX: 852-2480 3346



金洋實業有限公司

KAM YEUNG COMPANY LIMITED

EEZEE-DRY®

太陽牌活動晾衫架
Solar Brand Drying Rack

專營：鋁質不鏽鋼製品、活動晾衫架
各款信箱、保安門閘、家庭用品
遙控電動窗簾

易曬牌活動晾衫架
Aluminium Drying Rack

Your Ref:

Our Ref:

Date:

Job Reference (Photos)

Supply & Install of Open & Close Curtain Systems at L42 Star Room, Langham Place Hotel, H. K.

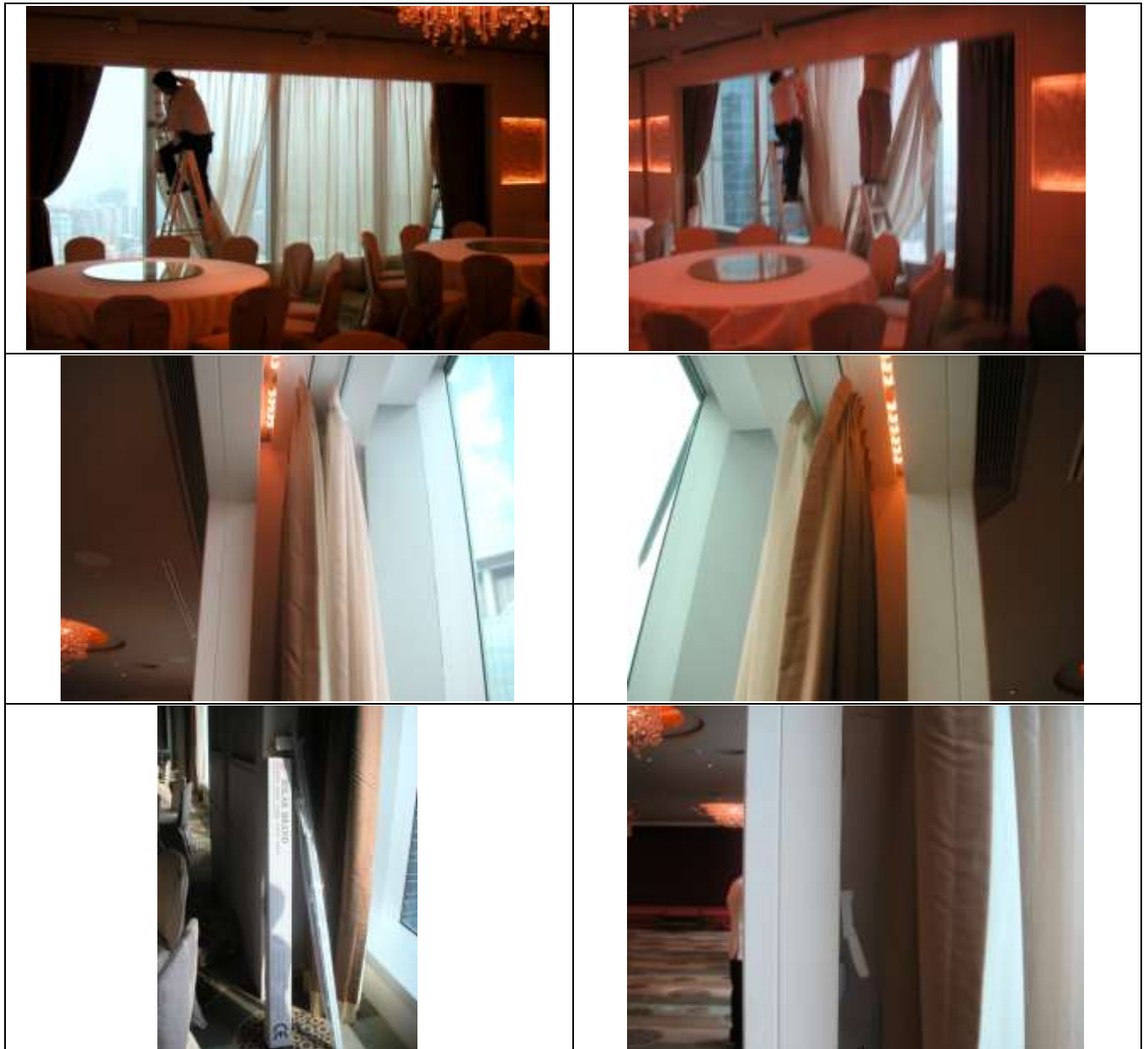

ADDRESS : FLAT C, 2/FL., BLOCK 3, GOLDEN DRAGON INDUSTRIAL CENTRE,
172-180 TAI LIN PAI ROAD, KWAI CHUNG, N. T., KOWLOON, HONG KONG
WEBSITE : <http://www.kamyeung.com> E-MAIL: kamyeung1980@yahoo.com.hk
kamyeung1990@gmail.com

TEL: 852-2428 3296, 2424 7485
FAX: 852-2480 3346



金洋實業有限公司

KAM YEUNG COMPANY LIMITED

EEZEE-DRY®

太陽牌活動晾衫架
Solar Brand Drying Rack

專營：鋁質不鏽鋼製品、活動晾衫架
各款信箱、保安門閘、家庭用品
遙控電動窗簾

易曬牌活動晾衫架
Aluminium Drying Rack

Your Ref:

Our Ref:

Date:

Job Reference (Photos)

Supply & Install of Skylight Shape Systems at Emperor Height, Ho Man Tin, H. K.

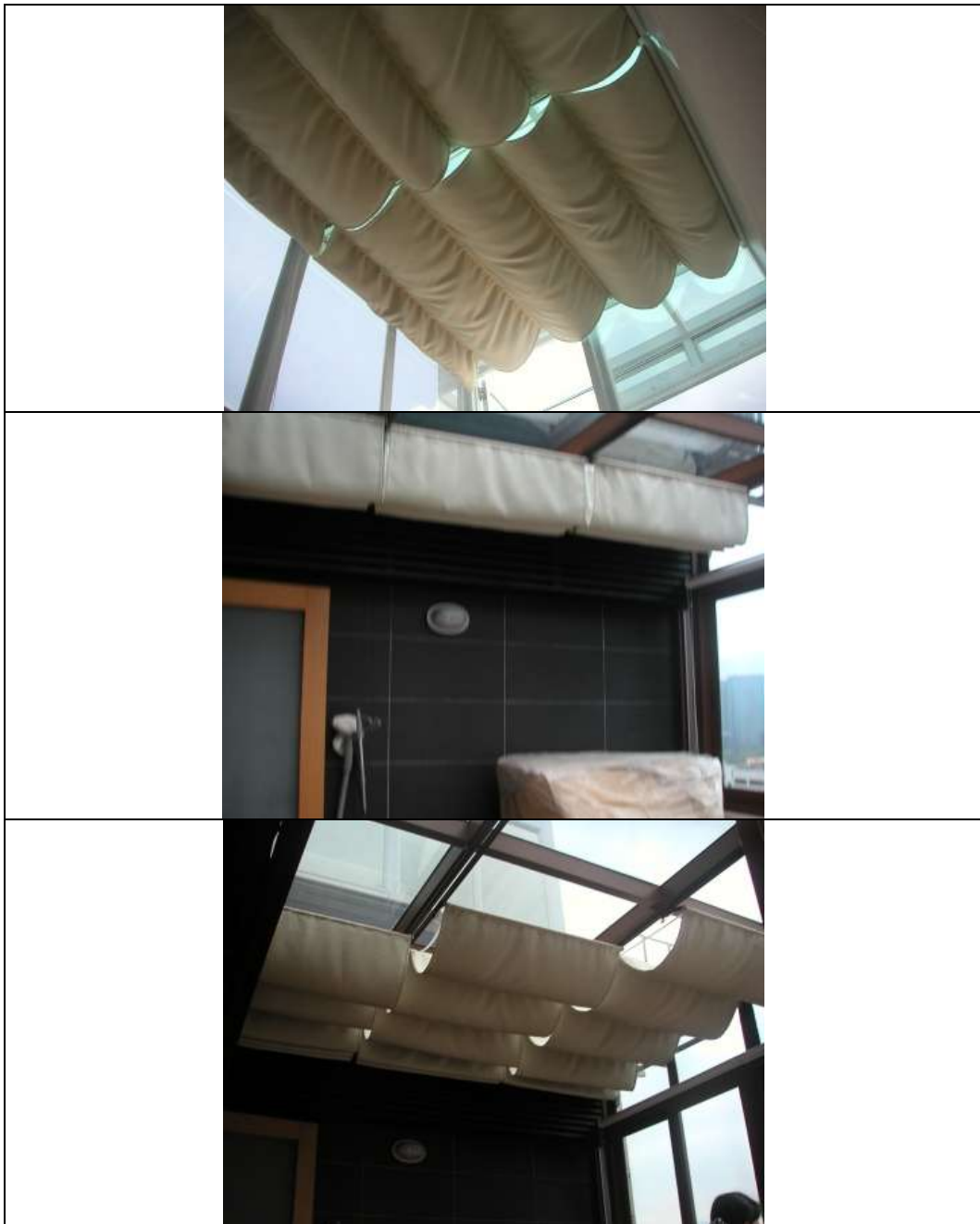

ADDRESS : FLAT C, 2/FL., BLOCK 3, GOLDEN DRAGON INDUSTRIAL CENTRE,
172-180 TAI LIN PAI ROAD, KWAI CHUNG, N. T., KOWLOON, HONG KONG
WEBSITE : <http://www.kamyung.com> E-MAIL: kamyung1980@yahoo.com.hk
kamyung1990@gmail.com

TEL: 852-2428 3296, 2424 7485
FAX: 852-2480 3346



金洋實業有限公司

KAM YEUNG COMPANY LIMITED

EEZEE-DRY®

太陽牌活動晾衫架
Solar Brand Drying Rack

專營：鋁質不鏽鋼製品、活動晾衫架
各款信箱、保安門閘、家庭用品
遙控電動窗簾

易曬牌活動晾衫架
Aluminium Drying Rack

Your Ref:

Our Ref:

Date:

工作記錄

Job Reference

ADDRESS : FLAT C, 2/FL., BLOCK 3, GOLDEN DRAGON INDUSTRIAL CENTRE,
172-180 TAI LIN PAI ROAD, KWAI CHUNG, N. T., KOWLOON, HONG KONG
WEBSITE : <http://www.kamyeung.com> E-MAIL: kamyeung1980@yahoo.com.hk
kamyeung1990@gmail.com

TEL: 852-2428 3296, 2424 7485
FAX: 852-2480 3346



金洋實業有限公司

EEZEE-DRY®

KAM YEUNG COMPANY LIMITED

太陽牌活動晾衫架
Solar Brand Drying Rack

專營：鋁質不鏽鋼製品、活動晾衫架
各款信箱、保安門閘、家庭用品
遙控電動窗簾

易曬牌活動晾衫架
Aluminium Drying Rack

Your Ref :

<Page 1>

Our Ref :

Date, 20th Oct., 2010.

Dear Sir / Madam,

Thank you very much for your enquiry of our product “**Solar Brand**” Remote Control Curtain System. We would like to supply the following “**Job Reference**” for your record and reference.

Job Reference

Date	Description / Projects	Type
13-06-1996	Asia Standard – Site at Aberdeen, Hong Kong	Open & Close Curtain
14-07-1998	Artistic Castle – Supply to HK Curtain Shop	“ ”
11-08-1998	“ ” “ ”	“ ”
15-09-1998	Ikeda Development – Supply to HK Curtain Shop	“ ”
10-12-1998	“ ” “ ”	“ ”
01-02-1999	Asia Standard – Site at 368 Shaukeiwan Rd., HK	“ ”
16-03-1999	Ikeda Development – Supply to HK Curtain Shop	“ ”
12-11-1999	Shing Fat Const – Supply to HK Curtain Shop	“ ”
25-08-2000	“ ” “ ”	“ ”
28-06-2001	Sarana Upholerstery – Export to Sri Lanka	“ ”
03-07-2001	Benalla Ltd – Supply to HK Design Company	“ ”
30-07-2001	Shing Fat Const – Supply to HK Curtain Shop	“ ”
06-12-2001	Titian Internation – Supply to HK Trading Company	“ ”
24-07-2002	Ocean Leader – Export to UK (OEM) brand name: Regency	“ ”
27-11-2002	Textile Network – Export to New Zealand	Open & Close Curtain and Roller Blind
17-04-2003	Excel-Zone – Supply to HK Curtain Shop	Open & Close Curtain
16-06-2003	Residential Building at Zhuwai District, Shanghai, China	“ ”
16-07-2003	Image Style Co Ltd – Export to Thailand	“ ”
14-05-2004	“ ” “ ”	“ ”
17-05-2004	Fouad & Khalid – Export to Saudi Arabia	“ ”
15-08-2004	Shanghai Regent Hotel, Shanghai, China	Open & Close Curtain and Roller Blind
31-08-2004	Image Style Co Ltd – Export to Thailand	Open & Close Curtain
25-10-2004	Ocean Leader – Export to UK (OEM) brand name: Regency	“ ”
01-12-2004	“ ” “ ”	“ ”
23-12-2004	“ ” “ ”	“ ”
06-01-2005	VK-Furniture – Export to Finland	Open & Close Curtain
19-01-2005	Ocean Leader – Export to UK (OEM) brand name: Regency	“ ”
21-01-2005	“ ” “ ”	“ ”
22-02-2005	Ocean Leader – Export to UK (OEM) brand name: Regency	“ ”
02-04-2005	Meridian – Export to USA	“ ”

(P. T. O.)

ADDRESS : FLAT C, 2/FL., BLOCK 3, GOLDEN DRAGON INDUSTRIAL CENTRE,
172-180 TAI LIN PAI ROAD, KWAI CHUNG, N. T., KOWLOON, HONG KONG
WEBSITE : <http://www.kamyung.com> E-MAIL: kamyung1980@yahoo.com.hk

TEL: 852-2428 3296, 2424 7485
FAX: 852-2480 3346



金洋實業有限公司

EEZEE-DRY®

KAM YEUNG COMPANY LIMITED

太陽牌活動晾衫架
Solar Brand Drying Rack

專營：鋁質不鏽鋼製品、活動晾衫架
各款信箱、保安門閘、家庭用品
遙控電動窗簾

易曬牌活動晾衫架
Aluminium Drying Rack

Your Ref :

<Page 2>

Our Ref :

Date, 20th Oct., 2010.

Date	Description / Projects	Type
08-04-2005	Fouad & Khalid – Export to Saudi Arabia	Open & Close Curtain
17-05-2005	Ocean Leader – Export to UK (OEM) brand name: Regency	“ ”
18-07-2005	“ ” “ ”	“ ”
26-07-2005	Classic Interior – Export to Czech Republic	“ ”
09-09-2005	Ocean Leader – Export to UK (OEM) brand name: Regency	“ ”
19-10-2005	Image Style Co Ltd – Export to Thailand	“ ”
19-12-2005	“ ” “ ”	“ ”
21-01-2006	Ocean Leader – Export to UK (OEM) brand name: Regency	“ ”
21-01-2006	Curtain Call – Export to USA (OEM) brand name: CurtainCall	Open & Close Curtain, Vertical Blind
10-03-2006	“ ” “ ”	“ ”
28-03-2006	Cross Ocean Hotel – Shanghai, China	Open & Close Curtain
09-05-2006	Add-a-Motor – Export to USA (OEM) brand name: 2000	6M DIY Curtain System
15-05-2006	Kudos Trading Co – Site at Hac Sa Van, Macao	Open & Close Curtain
14-06-2006	Kornblums – Export to Australia (OEM) brand name: bosetti	“ ”
14-06-2006	Verticales Reforma – Export to Mexico	3M DIY Curtain System, Vertical Blind
16-06-2006	Curtain Call – Export to USA (OEM) brand name: CurtainCall	4M DIY Curtain System & Vertical Blind
20-07-2006	“ ” “ ”	Open & Close Curtain
06-10-2006	Blue Sky Hotel – Mongolia, China	Open & Close Curtain
12-10-2006	Hunter Douglas Co Ltd – Export to USA	Open & Close Curtain, Roller Blind, Vertical Blind and Venetian Blind
16-10-2006	Curtain Call – Export to USA (OEM) brand name: CurtainCall	Open & Close Curtain
23-10-2006	Add-a-Motor – Export to USA (OEM) brand name: 2000	6M DIY Curtain System
06-11-2006	Langham Place Hotel, Kowloon, Hong Kong	Open & Close Curtain
10-11-2006	Add-a-Motor – Export to USA (OEM) brand name: 2000	6M DIY Curtain System
29-12-2006	Acesite Hotel, Hong Kong	Open & Close Curtain and Roller Blind System
08-01-2007	Emtrol – Export to Singapore	Open & Close Curtain, Roller Blind, Vertical Blind and Venetian Blind
10-04-2007	Add-a-Motor – Export to USA (OEM) brand name: 2000	6M DIY Curtain System
18-04-2007	Langham Place Hotel – L42 Star Room	Open & Close Curtain
28-05-2007	Image Style Co Ltd – Export to Thailand	“ ”
28-05-2007	Pacific Coffee Co – Citygate Branch, Tung Chung	Roller Blind System
06-06-2007	Curtain Call – Export to USA (OEM) brand name: CurtainCall	Open & Close Curtain
20-07-2007	Capitco – Export to Philippines	2M DIY Curtain System
27-07-2007	Curtain Call – Export to USA (OEM) brand name: CurtainCall	Open & Close Curtain
01-08-2007	Eurasia Group - 何文田御景台	Skylight Shape

(P. T. O.)

ADDRESS : FLAT C, 2/FL., BLOCK 3, GOLDEN DRAGON INDUSTRIAL CENTRE,
172-180 TAI LIN PAI ROAD, KWAI CHUNG, N. T., KOWLOON, HONG KONG
WEBSITE : <http://www.kamyung.com> E-MAIL: kamyung1980@yahoo.com.hk

TEL: 852-2428 3296, 2424 7485
FAX: 852-2480 3346



金洋實業有限公司

EEZEE-DRY®

KAM YEUNG COMPANY LIMITED

太陽牌活動晾衫架
Solar Brand Drying Rack

專營：鋁質不鏽鋼製品、活動晾衫架
各款信箱、保安門閘、家庭用品
遙控電動窗簾

易曬牌活動晾衫架
Aluminium Drying Rack

Your Ref :

<Page 3>

Our Ref :

Date, 20th Oct., 2010.

Date	Description / Projects	Type
24-08-2007	Add-a-Motor – Export to USA (OEM) brand name: 2000	6M DIY Curtain System
30-08-2007	Manboloy Const Engrg – 澳門黑沙灣寰宇天下 (La Cite)	Open & Close Curtain A
24-09-2007	Home Touch Ltd – 大埔日榮花園	“ ”
18-10-2007	B & Q Asia – Supply to Home Improvement Retailer in HK	2~6M DIY Curtain System
20-10-2007	Meridian NY – Export to USA	Open & Close Curtain A+B
13-11-2007	e-Home Automation – Export to Dubai, UAE (OEM) brand name: e-Home	Open & Close Curtain, Roman Blind and Skylight Shape
14-11-2007	Add-a-Motor – Export to USA (OEM) brand name: 2000	6M DIY Curtain System
24-11-2007	Curtain Call – Export to USA (OEM) brand name: CurtainCall	Open & Close Curtain
16-01-2008	Add-a-Motor – Export to USA (OEM) brand name: 1000	3M DIY Curtain System
27-02-2008	B & Q Asia – Supply to Home Improvement Retailer in HK	3M DIY Curtain System
05-03-2008	F & K Al-Anasari – Export to Saudi Arabia	Roller Blind (w/ fabric)
11-03-2008	Curtain Call – Export to USA (OEM) brand name: CurtainCall	Open & Close Curtain
01-04-2008	B & Q Asia – Supply to Home Improvement Retailer in HK	2, 3 & 5M DIY Curtain System
02-04-2008	Add-a-Motor – Export to USA (OEM) brand name: 2000	6M DIY Curtain System
12-04-2008	Auto Tringle - Export to Tunisia (OEM) brand name: Auto Tringle	Open & Close Curtain, Roman Blind, Vertical Blind and Venetian Blind
07-05-2008	e-Home Automation – Export to Dubai, UAE (OEM) brand name: e-Home	Open & Close Curtain A+B (for home automation system)
14-05-2008	Digitcom Technology – Export to Dubai, UAE (OEM) brand name: sunseeker	Open & Close Curtain, Roller Blind, Vertical Blind, Venetian Blind and Skylight Shape (for home automation system)
15-05-2008	Add-a-Motor – Export to USA (OEM) brand name: 1000	3M DIY Curtain System
“ ”	B & Q Asia – Supply to Home Improvement Retailer in HK	3M DIY Curtain System
03-06-2008	Add-a-Motor – Export to USA (OEM) brand name: 2000	6M DIY Curtain System
12-06-2008	Manboloy Const Engrg – 澳門黑沙灣寰宇天下 (La Cite)	Open & Close Curtain B
16-06-2008	Image Style Co Ltd – Export to Thailand	Open & Close Curtain A
01-07-2008	e-Home Automation – Export to Dubai, UAE (OEM) brand name: e-Home	Open & Close Curtain A
04-07-2008	e-Home Automation – Export to Dubai, UAE (OEM) brand name: e-Home	Open & Close Curtain A+B
15-07-2008	Wui Li Engrg Co – Renovation Works to 38/F World Trade Ctr Club	Roller Blind (w/ fabric)
05-08-2008	DDL Contracting (Macau) Ltd – Renovation Works to 28/F of Luk Kwok Hotel in Wanchai, HK	Open & Close Curtain A+B
23-08-2008	Smarthouse Technology Ltd - Export to England	Venetian Blind (w/ wood slat)
03-09-2008	Image Style Co Ltd – Export to Thailand	Open & Close Curtain B
09-09-2008	Add-a-Motor – Export to USA (OEM) brand name: 2000	6M DIY Curtain System
22-09-2008	B & Q Asia – Supply to Home Improvement Retailer in HK	3M & 4M DIY Curtain System
30-10-2008	e-Home Automation – Export to Dubai, UAE (OEM) brand name: e-Home	Open & Close Curtain A
12-11-2008	Curtain Call – Export to USA (OEM) brand name: CurtainCall	Open & Close Curtain, Roller Blind

(P. T. O.)

ADDRESS : FLAT C, 2/FL., BLOCK 3, GOLDEN DRAGON INDUSTRIAL CENTRE,
172-180 TAI LIN PAI ROAD, KWAI CHUNG, N. T., KOWLOON, HONG KONG
WEBSITE : <http://www.kamyung.com> E-MAIL: kamyung1980@yahoo.com.hk

TEL: 852-2428 3296, 2424 7485
FAX: 852-2480 3346



金洋實業有限公司

EEZEE-DRY®

KAM YEUNG COMPANY LIMITED

太陽牌活動晾衫架
Solar Brand Drying Rack

專營：鋁質不鏽鋼製品、活動晾衫架
各款信箱、保安門閘、家庭用品
遙控電動窗簾

易曬牌活動晾衫架
Aluminium Drying Rack

Your Ref :

<Page 4>

Our Ref :

Date, 20th Oct., 2010.

Date	Description / Projects	Type
28-11-2008	B & Q Asia – Supply to Home Improvement Retailer in HK	3M & 4M DIY Curtain System
15-12-2008	Add-a-Motor – Export to USA (OEM) brand name: 2000	6M DIY Curtain System
29-12-2008	Pretterior Works & Consultants Co Ltd – Renovation Works to L1, The Long Beach, 8 Hoi Fai Road, West Kowloon, HK	Roller Blind (w/ fabric)
08-01-2009	B & Q Asia – Supply to Home Improvement Retailer in HK	4M DIY Curtain System
11-01-2009	e-Home Automation – Export to Dubai, UAE (OEM) brand name: e-Home	Roller Blind, Vertical Blind & Venetian Blind (for home automation system)
18-02-2009	Ste SEEG – Export to France	4M DIY Curtain System
24-02-2009	Add-a-Motor – Export to USA (OEM) brand name: 1000 (w/HA)	3M DIY Curtain System
04-03-2009	B & Q Asia – Supply to Home Improvement Retailer in HK	3M DIY Curtain System
07-03-2009	B & Q Asia – Supply to Home Improvement Retailer in HK	Open & Close Curtain A
10-03-2009	e-Home Automation – Export to Dubai, UAE (OEM) brand name: e-Home	2M/3M/4M DIY Curtain System (A+B Motor)
20-03-2009	B & Q Asia – Supply to Home Improvement Retailer in HK	3M DIY Curtain System
25-03-2009	Add-a-Motor – Export to USA (OEM) brand name: 2000 (w/HA)	6M DIY Curtain System
30-03-2009	Meridian Trading – Export to USA	Roller Blind (w/ 32mm tube)
10-04-2009	Chinatown Lumber - Export to USA	Open & Close Curtain A+B and Vertical Blind, included alum. track
06-05-2009	B & Q Asia – Supply to Home Improvement Retailer in HK	Open & Close Curtain A
22-05-2009	Green Power - Export to China	3M & 4M DIY Curtain System
05-06-2009	F & K Al-Anasari – Export to Saudi Arabia	Roller Blind System
23-06-2009	e-Home Automation – Export to Dubai, UAE (OEM) brand name: e-Home	Open & Close Curtain A (for home automation system)
02-07-2009	Add-a-Motor – Export to USA (OEM) brand name: 1000/2000 (w/HA)	3M & 6M DIY Curtain System
15-07-2009	Maurice Laude – Supply to Home Improvement Retailer in HK	4M, 5M & 6M DIY Curtain System
13-08-2009	Great Treasure Int'l Ltd – Site at Soars Road, T.S.T., Kowloon	Roller Blind (w/ fabric)
14-08-2009	Digitcom Technology – Export to Dubai, UAE (OEM) brand name: sunseeker	4M & 5M Clutch Curtain System
17-08-2009	Great Treasure Int'l Ltd –旺角建材城 3/F	Open & Close Curtain A+B, Roller Blind and Vertical Blind
14-10-2009	Digitcom Technology – Export to Dubai, UAE (OEM) brand name: sunseeker	Clutch Curtain System + Timer
29-10-2009	Curtain Call – Export to USA (OEM) brand name: CurtainCall	Open & Close Curtain
12-11-2009	Add-a-Motor – Export to USA (OEM) brand name: 1000 (w/HA)	3M DIY Curtain System
26-11-2009	Digitcom Technology – Export to Dubai, UAE (OEM) brand name: sunseeker	Open & Close Curtain
28-11-2009	Digitcom Technology – Export to Dubai, UAE (OEM) brand name: sunseeker	3M Clutch Curtain System + Timer
01-12-2009	Curtain Call – Export to USA (OEM) brand name: CurtainCall	Roller Blind
05-12-2009	Winnertoys - Renovation Works to Rm. 1102, Empire Ctr., 68 Mody Rd, TST	Roller Blind (w/ fabric)
21-12-2009	Decorama - Export to Australia	4M DIY Curtain System
06-01-2010	Add-a-Motor – Export to USA (OEM) brand name: 2000 (w/HA)	6M DIY Curtain System
08-01-2010	Curtain Call –Export to USA (OEM) brand name: CurtainCall	Open & Close Curtain
13-01-2010	Decorama - Export to Australia	4M/6M DIY Curtain System

(P. T. O.)

ADDRESS : FLAT C, 2/FL., BLOCK 3, GOLDEN DRAGON INDUSTRIAL CENTRE,
172-180 TAI LIN PAI ROAD, KWAI CHUNG, N. T., KOWLOON, HONG KONG
WEBSITE : <http://www.kamyung.com> E-MAIL: kamyung1980@yahoo.com.hk

TEL: 852-2428 3296, 2424 7485
FAX: 852-2480 3346



金洋實業有限公司

KAM YEUNG COMPANY LIMITED

EEZEE-DRY®

太陽牌活動晾衫架
Solar Brand Drying Rack

專營：鋁質不鏽鋼製品、活動晾衫架
各款信箱、保安門閘、家庭用品
遙控電動窗簾

易曬牌活動晾衫架
Aluminium Drying Rack

Your Ref :

<Page 5>

Our Ref :

Date, 20th Oct., 2010.

Date	Description / Projects	Type
17-03-2010	Langham Place Hotel – Rm. 4001 & L4	Open & Close Curtain, Roller Blind
20-03-2010	Curtain Call –Export to USA (OEM) brand name: CurtainCall	Open & Close Curtain
23-03-2010	Add-a-Motor – Export to USA (OEM) brand name: Model 1000 / 2000 (w/HA)	3M / 6M DIY Curtain System
07-04-2010	Curtain Call –Export to Canada (OEM) brand name: CurtainCall	Roller Blind System, w/ Alum. Tube & Lower Channel
09-04-2010	Digitcom Technology – Export to Dubai, UAE (OEM) brand name: sunseeker	3M Clutch Curtain System, Roller Blind & Vertical Blind
19-04-2010	Decorama - Export to Australia	Curtain System
21-04-2010	Virginio SPICACCI-MINERVINI – Export to France	2M DIY A+B Curtain System, Clutch A+B Motor, Roller Blind & Vertical Blind
11-05-2010	Digitcom Technology – Export to Dubai, UAE (OEM) brand name: sunseeker	3M Clutch Curtain System & Roller Blind
14-05-2010	Contractor - Renovation Works at 118 Connaught Road West, HK	Roller Blind (w/ fabric)
01-06-2010	Add-a-Motor – Export to USA (OEM) brand name: Model 1000 / 2000 (w/HA)	3M / 6M DIY Curtain System
12-07-2010	Digitcom Technology – Export to Dubai, UAE (OEM) brand name: sunseeker	3M Clutch Curtain System, Roller Blind & Vertical Blind
22-07-2010	Add-a-Motor – Export to USA (OEM) brand name: Model 2000 (w/HA)	6M DIY Curtain System
23-07-2010	B. Das – Export to India brand name: SOLAR Brand	2M DIY Curtain System, Roller Blind & Vertical Blind
16-08-2010	Digitcom Technology – Export to Dubai, UAE (OEM) brand name: sunseeker	Open & Close A+B Curtain & PCB
21-08-2010	Digitcom Technology – Export to Dubai, UAE (OEM) brand name: sunseeker	Open & Close A+B Curtain & 3M Clutch Curtain System
27-08-2010	Digitcom Technology – Export to Dubai, UAE (OEM) brand name: sunseeker	Open & Close A+B Curtain & 3M Clutch Curtain System
17-09-2010	Digitcom Technology – Export to Dubai, UAE (OEM) brand name: sunseeker	3M Clutch Curtain System, Roman Blind & Skylight Shape.
06-10-2010	Add-a-Motor – Export to USA (OEM) brand name: Model 1000 (w/HA)	3M DIY Curtain System

Should you have further enquiry, please do not hesitate to contact us.

Yours faithfully,
Kam Yeung Company Limited
Peter Ho

ADDRESS : FLAT C, 2/FL., BLOCK 3, GOLDEN DRAGON INDUSTRIAL CENTRE,
172-180 TAI LIN PAI ROAD, KWAI CHUNG, N. T., KOWLOON, HONG KONG
WEBSITE : <http://www.kamyung.com> E-MAIL: kamyung1980@yahoo.com.hk

TEL: 852-2428 3296, 2424 7485
FAX: 852-2480 3346